



PHONE
(989) 435-7080

3195 LYLE ROAD
BEAVERTON, MICHIGAN 48612

FAX
(888) 4 THE WIN

Rotor Installation Instructions

Hat Mounted Rotors

Callout	Part	Spec.	Howe P.N.
1	Hat	GT – 5x4.75	20573
		GT – 5x5	20574
		Narrow GT – 5x5	20574N
		GT - 5x5 (small T-nut)	20575
		Rear GT	20579
2	T-nut and Bolts	Standard T-nut Kit Small T-nut Kit	36575 36575N
3	Tabs	For AP rotor	36573G
4	Drive Flange	GT Straight	20545
		GT Cambered	20546
5	Gasket	GT	20552
-	Dust Cap	GT Bullet	20537
		GT Low Profile	20536

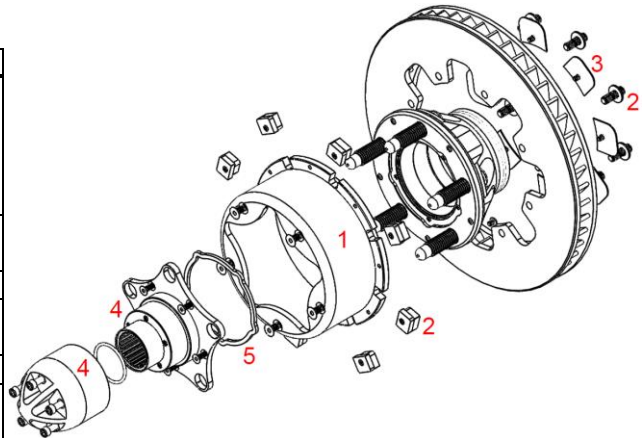

Figure 1 - Shown with straight drive flange, rear hat

1. Insert your 8 T-nuts into the slots in the rotor hat. There are two sizes of T-nuts. The narrow hat and the 20575 hat take small (.465") t-nuts. All other hats take standard (.715") T-nuts. They must be oriented as in *figure 1*, with the larger part of the T on the outward face of the hat and the threaded holes favored toward the center.
2. Insert your 5/16"-18 x 7/8" rotor bolts with washers through the rotor and into the T-nuts, attaching the rotor to the hat. **Torque the rotor bolts to 20 ft. lbs.**
3. There are holes through the heads of the rotor bolts for safety wire. Safety wire all rotor bolts as shown in *figure 2*.
4. If you have an AP rotor, you can bolt tabs (36573G) to the hat between the flanges of the rotor to restrict air flow. Tabs fit AP rotors only.
5. Attach the hat to the hub. The hat bolts to the face of the hub with five 1/4"-20 screws.
6. If not already attached, bolt on your drive flange or dust cap. Both attach with five 10-32 screws. If using a drive flange, insert a 20552 GT gasket in the recess between the flange and the hub. **GT drive flanges fit only with the 20579 rear GT hat. Dust caps fit with all other hats.**



Figure 2 - Properly installed safety wire

Direct Mounted Rotors

Rotor Bolt Kit – P.N. 21518

1. Insert your 5/16"-18 x 1" bolts with washers through the hub and into the rotor. (*figure 3*) Bolts can be inserted in either direction, but we recommend them oriented with the thread/nut on the inside.
2. **Torque the rotor bolts to 27 ft. lbs.** Direct mount rotors with lock nuts do not require safety wire.
3. If not already attached, bolt on your drive flange or dust cap. If using a drive flange, insert a 20550 gasket in the recess between the flange and hub. Drive flanges attach with two 3/8"-16 screws. Dust caps attach with three 10-32 screws.

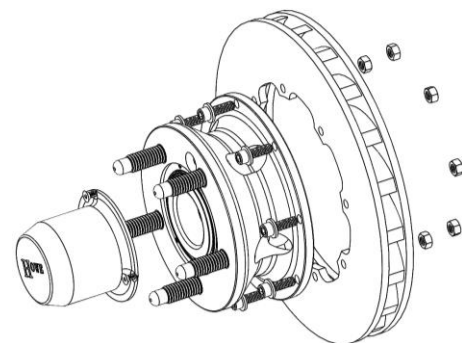

Figure 3 - Direct mounted rotor, dust cap